

## **BIO BINS QUICK GUIDE**

Please find below further information on our new sustainable clinical Bio-bin waste containers

Please note orders will be able to be placed via our usual methods, Web-Portal, Phone or Email from W/C Monday 19<sup>th</sup> April with deliveries starting from Tuesday 4<sup>th</sup> May 2021 onwards.

**Product Code:** BIOPOM5

**Product Name:** 5 litre Pharmaceutical container

**Dimensions:** 215mm (H) x 175mm (W) x 175mm (D) assembled

**Description:** Pharmaceutical 5 litre (blue) (POM) prescription only medicines out of date medicines, empty vials, denatured drugs etc (POM) EWC 18.02.08

**CANNOT BE USED FOR SHARPS**

**Assembly Guide:** Please see Page 3 below



**Product Code:** BIOPOM30

**Product Name:** 30 litre Pharmaceutical container

**Dimensions:** 415mm (H) x 280mm (W) x 280mm (D) assembled

**Description:** Pharmaceutical 5 litre (blue) (POM) prescription only medicines out of date medicines, empty vials, denatured drugs etc (POM) EWC 18.02.08

**CANNOT BE USED FOR SHARPS**

**Assembly Guide:** Please see Page 4 below



**Product Code:** BIOCYTO30

**Product Name:** 30 litre Cytotoxic/Cytostatic container

**Dimensions:** 415mm (H) x 280mm (W) x 280mm (D)  
assembled

**Description:** Cytotoxic/Cytostatic 30 litre (Purple) EWC code 18.02.07. Clinical waste associated with EWC code 18.02.07

**CANNOT BE USED FOR SHARPS**

**Assembly Guide:** Please see Page 4 below



To help ensure the 30 litre containers are kept in the best possible condition we strongly recommended that you order and use the stand available below.

Please be aware drivers will not be allowed to collect bins which are broken, or show signs of damage, leakage or water damage.

**Product Code:** BIOSTD30

**Product Name:** Stand for 30 litre containers only

**Description:** 30 litre Stand on casters, for use with 30litre containers only

\*please be aware there is a 4-week lead time on this product\*



## 5 LITRE BIO BIN ASSEMBLY INSTRUCTIONS



1. Take flat Bio-bin<sup>®</sup> out of box and hold as shown

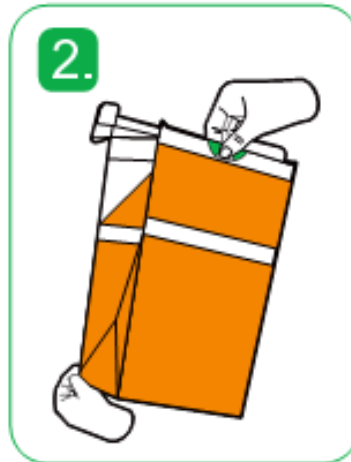

2. Pull Bio-bin<sup>®</sup> into shape



3. Fold sides outwards to prevent bin folding flat again



4. Bio-bin<sup>®</sup> is ready to use for non-sharp infectious waste



5. Fold top down towards centre



6. Press firmly in the centre of flap to temporary seal

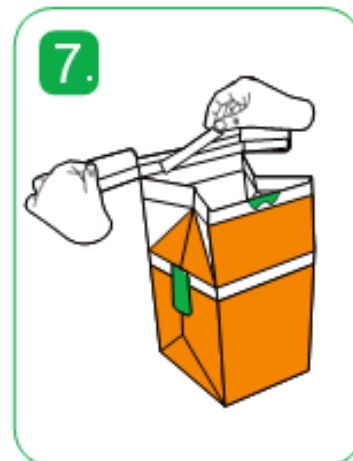

7. For a permanent seal, peel off release paper



8. Press together firmly and then fold down



9. Stick tabs to sides of Bio-bin<sup>®</sup>, lining up with printed area.

## 30 LITRE BIO BIN ASSEMBLY INSTRUCTIONS

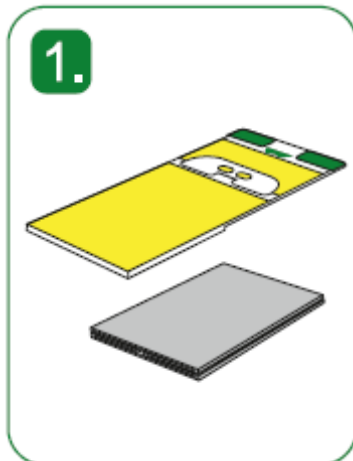

1. Take flat **Bio-bin®** and **bin-ert™** out of box



2. Unfold **Bio-bin®** and slide the **bin-ert** to the bottom of the bin, aligning the labels



3. Remove release paper on both sides of **bin-ert** to reveal tape

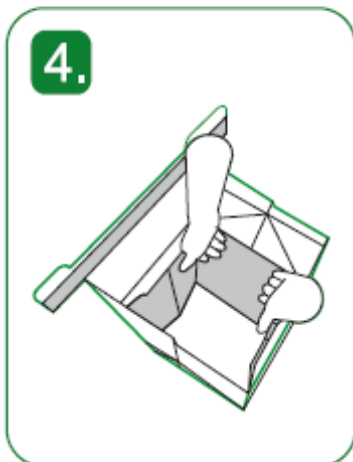

4. Push sides of bin out and press firmly to secure sides of **bin-ert** against inside of bin



5. Align new twist lock and turn clockwise to temporarily seal



6. When moving **Bio-bin®**, use the sturdy handles provided on the sides



7. For permanent seal, remove adhesive backing paper



8. Press down firmly to adhere, making sure twist lock is in the closed position



9. Stick tabs to sides of **Bio-bin®** firmly, line up with the outlined areas